



# WESTIN

## PRIME 360

### Built-in Unit

#### Installation, Operation and Maintenance

INTRODUCTION	1
IMPORTANT INFORMATION	1
EXTRACTION PERFORMANCE	1
INSTALLATION	2
SPECIFICATIONS	5
OPERATING INSTRUCTIONS	6
MAINTENANCE	7
DRAWINGS & ILLUSTRATIONS	8
GUARANTEE	14

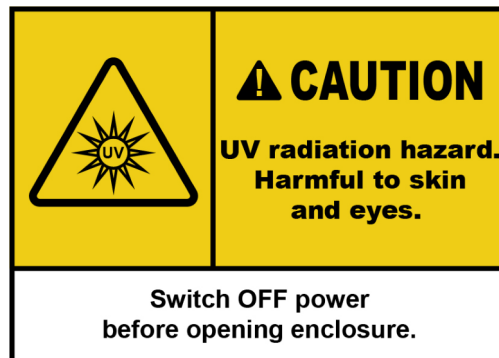

#### Unpacking

Remove all items from the packaging. Retain the packaging. If items are missing or damaged, please contact Westin for assistance.



## Installation, Operating & Maintenance Instructions

### 1. INTRODUCTION

During the cooking process odours are produced which, if left untreated, can linger for a long time after cooking has ceased. Your *Westin Prime 360* unit is a powerful built-in extractor that has been designed to complement your kitchen both in looks and performance in order to create a good environment for creative cooking and is ideal for applications where a conventional cooker hood is neither suitable nor desirable.

Featuring the *Westin 360* air recirculation technology, many of the benefits of ducted extraction products are delivered by this revolutionary air cleansing system, effectively removing unwanted odours from your kitchen and returning clean air back in to the room (Via customer supplied Pipework).

Of course, hygiene is also a priority in any kitchen and your *Westin Prime 360* not only serves to remove odours but also actively assists in the destruction of harmful bacteria, pathogens and allergens which may be present, thus helping to purify the air.

### 2. IMPORTANT INFORMATION

The exhaust air must not be discharged into a flue which is used for exhausting fumes from appliances supplied with energy other than electricity e.g. oil or gas-fired central heating boilers, gas-fired water heaters, etc.

Requirements of the relevant authorities concerning the discharge of exhaust air must be complied with.

#### WARNING

Proper care must be taken to ensure that the negative pressures caused by high performance extraction systems do not adversely affect the safe operation of certain types of fuel-burning appliances (gas, oil or solid fuel), including those installed in the kitchen and possibly also those installed in other parts of the house.

Where such fuel-burning appliances are installed, adequate ventilation MUST be provided in the room of installation, located and sized such that the negative pressure in the room created by the extractor does not exceed 4Pa.

In case of doubt, do not operate the extractor and fuel-burning appliance(s) simultaneously and consult an appropriate (for the fuel type) expert for advice.

#### ELECTRICAL SAFETY

This appliance requires an earth connection.

Ensure that the supply voltage corresponds to that marked on the rating label inside the extractor.

The extractor must be isolated from the electrical supply before carrying out any cleaning or maintenance operations.

Pay particular attention to fire risk when frying. To minimise the risk of fire, all instructions relating to cleaning the grease filters and removing grease deposits must be adhered to.

#### **Do not flambé under the extractor.**

The clearance between the hob and the lowest part (base) of the extractor should be within the following range, unless a greater distance is specified by your cooking appliance or furniture manufacturer:

- **minimum clearance distances:**
  - 550mm above electric hobs and cookers
  - 750mm above gas hobs and cookers, fryers
  - 760mm above wok burners, griddles, barbeques.

- maximum recommended clearance: 850mm

The minimum distance between the hob and the bottom of the extractor is essential for safety reasons and to prevent overheating of the extractor and its components.

### 3. SYSTEM PERFORMANCE

This type of extractor is designed to fit into a soffit, with only the underside visible when installed.

Because fumes spread out as they rise, try to position the extractor so it sits as far forward over the hob as is practicable in order to minimise fume escape.

In very simple terms, your *Prime 360* relies on two primary principals to maximise effectiveness:

Firstly, air is drawn into the extractor where particulate contaminants are captured by the HEPA filtration system.

The air is then discharged into the room after passing over a low power UV bulb within the air-box chamber.

Your *Prime 360* emits discharge air containing a concentration of reactive molecules which work effectively to break-down odours within the kitchen.

The potency of the contaminants will determine how long it takes to completely remove odours within the room - The discharged air mixes with other air in the room and is then drawn back through the extractor in a continuous cycle.

This mixing of the air is important and works best when the unit is installed at a higher level, maximising the mixing effect. Not only that, but warm contaminated air will rise up and be collected more effectively at higher level.

In summary, overall performance of the system is optimised when all of the air in the room is free to mix and enter the appliance unobstructed and the best way to ensure this is to install the unit at a higher level as this will prevent pockets of air potentially stagnating.

In order to maintain optimal performance, it is important to follow the cleaning and maintenance instructions in section 7. In brief, this entails keeping the grease & HEPA filters and accessible parts and surfaces clean and ensuring that the *Westin 360* air cleaning module's special UV composite lamp is periodically replaced.

### 4. INSTALLATION

The *Prime 360* range of built-in extractors are designed to slot into a cut-out/opening made in a horizontal soffit panel (usually the underside of kitchen furniture or inglenooks / chimney arrangements).

- **The soffit panel into which the unit is to be fixed must be between 15mm and 22mm thick.**

***Dimensioned drawings and illustrations to help with your installation can be found in Section 8 (page 7 onwards)***

#### 4.1. Prepare Your Opening

Prepare the opening into which the unit will be installed.

**Note:** Should you need to reinforce your furniture around the opening made then please ensure that the spring toggle clips which support the unit when installed will still be able to spring out and latch over the edge of your opening and hold the unit securely in place.



Installation, Operating & Maintenance Instructions

**The extractor exhausts via a top exit (which should never be covered). When planning and undertaking your installation, you must ensure adequate space around the top of the unit to allow recirculation air to flow away from any cabinet or structure (and back in to the room). This will help to reduce noise, moisture build-up & back-pressure.**

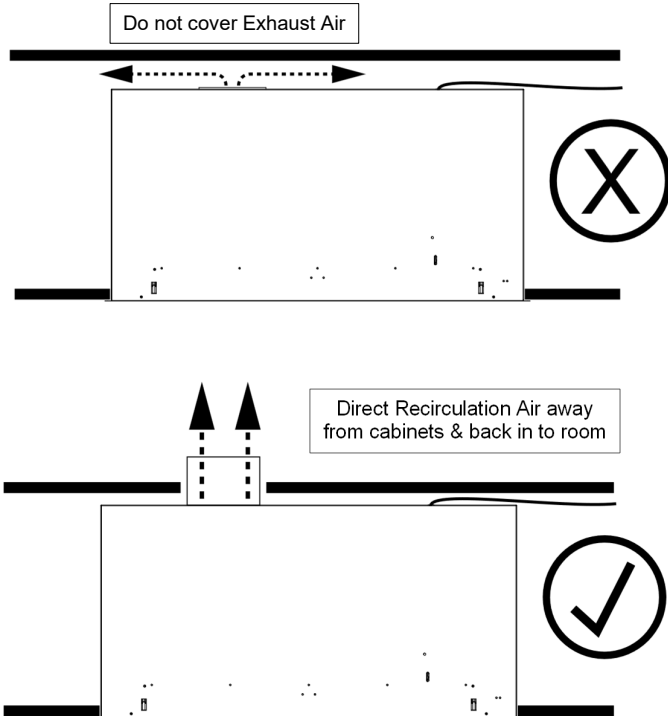

Soffit Cutting Guide (Thickness 15mm – 22mm (Maximum))	
Prime 360 800	780mm x 266mm
Prime 360 900	880mm x 266mm
Prime 360 1100	1080mm x 266mm

4.2. Electrical Installation

The *Prime* extractor is a fixed electrical appliance.

**ELECTRICAL HAZARD.  
DISCONNECT ELECTRICAL SUPPLY BEFORE  
PROCEEDING FURTHER**

The extractor is a stationary appliance supplied with an electrical supply flex and moulded 3 pin UK plug (3A) for connection to the electrical supply.

**The appliance must be fed from a 230Vac single phase electrical supply.** You may wish to terminate the electrical supply using a standard mains electrical socket positioned close to the extractors intended location.

Alternatively, you may terminate the electrical supply from a switched-fused spur. The spur should be located adjacent to the hood/cooker so that the supply can be disconnected from the hood using the switch. The means of disconnection from the supply must have a minimum contact separation of 3mm in all poles. A competent Part P registered electrical technician must perform the electrical installation.

The mains supply is connected as follows:

INCOMING SUPPLY CORD CONNECTIONS	
Core	Core Colour
Live	Brown
Neutral	Blue
Protective Earth	Green/Yellow

Make sure the switched-fused spur supplying the extractor is in the off position before connecting the appliance to the electrical supply.

4.3. Fixing the Extractor in Position

**When planning and undertaking your installation, you must ensure the extractor can be removed without disturbing electrical installations, should future servicing be required.**

Please note the following prior to commencing fixing the extractor in position:

- Two people are required to install units over 800mm wide; to lift, hold and fix the unit in position.
- The unit will need supporting close to the opening when attaching the recirculation ducting and making electrical connections.
- Do not remove protective tape until after the installation.

Proceed as follows:

**Remove the grease filters:** The clip-in grease filters have an integrated sprung latch mechanism. Release the latch by pulling the lever to remove the filter and to expose the HEPA filters.

Grasp the steel frame surrounding HEPA filter at the tabs and pull down to release the frame from the magnets.

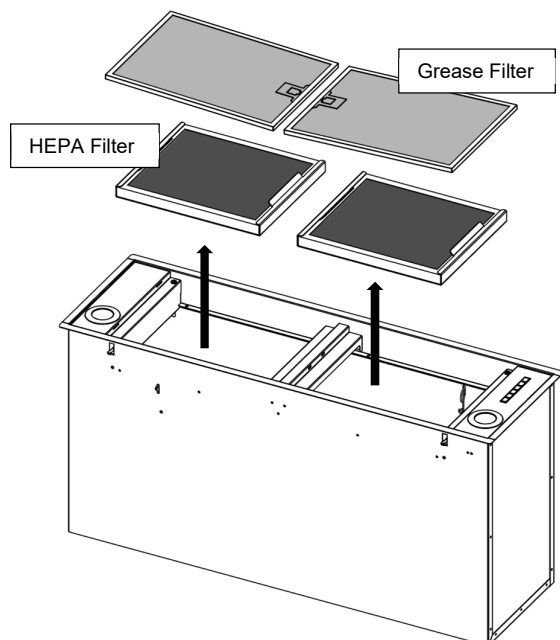



Installation, Operating & Maintenance Instructions

- The extractor is held securely in place within the furniture opening by 4 adjustable spring toggle clips that protrude through slots in the outer casing of the unit.

Screws for adjusting the height of the spring toggle clips are located behind the grease filters, set into the left and right filter opening flange (See diagram below).

The spring toggle clips are moved up (away from the base flange) by turning the screws anti-clockwise and down (towards the flange) by turning the screws clockwise.

**Do not use power drivers to turn the spring toggle clip height adjustment screws.**

**Ensure that all spring toggle clips are adjusted such that each is in the fully open position at the top of its slot and can fold fully in and out of the slot when pushed.** A fully open clip flap will protrude from the casing by approximately 10mm.

- Supplementary support of the unit is provided by two sprung wire safety clips which are there to prevent the extractor falling during removal. **The wire safety clips should be disabled for installation** by pulling the clip release ring back until the clip is clear of its slot in the body of the extractor and then sliding it over to one side, so that the wire clip no longer protrudes through its slot but rests against the inner casing of the extractor.

- The sprung safety clips are there to catch the unit and to prevent it falling from the opening in the soffit. Lower the extractor carefully until the safety clips are supporting it - if the opening has not been correctly prepared, then the safety clips may not catch on the edge of the opening, so be prepared to continue lowering the unit down and out of the opening.

- Two people** are required to lower the unit safely.

The unit is released for final lowering by each person pulling the safety clip release back into the extractor, whilst supporting the unit with their other hand (thus disengaging them from the soffit so that the unit can be carefully lowered).

5. SPECIFICATIONS

Electrical Specifications	
Supply Voltage	230V~ 50Hz
LED Task Lighting (Per Lamp) power input	2.6W
Fan Power Input	170W
360 Air Cleaning Module Power Input	4W
<b>Total power input</b>	<b>See Rating Label</b>
<b>Electrical Supply Protective Fuse Rating</b>	<b>3A</b>

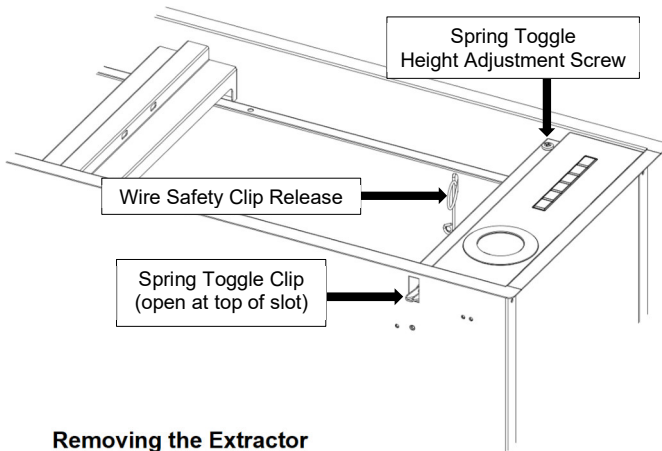

4.4. Removing the Extractor

- First remove the grease filters and ensure that the sprung safety clip is correctly set. Only the clip release hoop and mounting arm should be on the inside of the unit with the rest of the clip fully through the slot in the extractor casing (as in Fig 1). If in doubt, pull the clip release to reveal the clip latch and make sure that it passes fully back through the casing when released.
- With the safety clips correctly set, turn the spring toggle height adjustment screws anti-clockwise. The extractor will gradually start to lower. This is best done in stages, working your way around the 4 screws thus lowering the unit evenly and avoiding undue stress on any one spring toggle.

Note: as you turn the adjustment screws, the spring toggles gradually rise until they reach the top of their slots, after which they start to retract into the extractor casing.

You will know when the spring toggles start to retract because the extractor will start to rise up into the soffit rather than lower. When this happens, you should support the extractor and continue to turn the screws carefully clockwise. When the spring toggles have retracted sufficiently, the unit will no longer be held in place by them and the unit may drop suddenly if you are not supporting the extractor.

**The Prime 360 unit should always be used in conjunction with a supply of fresh air. This allows the antioxidant phase of the air treatment process to work more efficiently.**

**Do not operate (or leave the appliance running) for more than 6 hours (total) during any 24-hour period.**

For detailed performance, specification and energy efficiency information please refer to the product fiche for your product



Installation, Operating & Maintenance Instructions

6. OPERATING INSTRUCTIONS

Radio Remote Controlled Models (If purchased)

- Switch on the power at the fused spur.
- Then Immediately turn on the remote control (⏻).
- Then immediately press and hold (☼) until the lights illuminate.

Should the extractor fail to respond to commands from the remote-control, please check that the power is 'on' and the internal appliance reset switch is in the 'ON' position (factory default). The reset switch is a latching red push-switch located in the chamber behind the door panel / filter.

If you experience interference problems, or the remote appears to be faulty from new, then a different radio transmission code may be required.

Refer to the instruction leaflet included with the remote control regarding transmission code changes before seeking assistance.

Pushbutton Models

Pushbutton Functions

(For models with pushbutton controls)

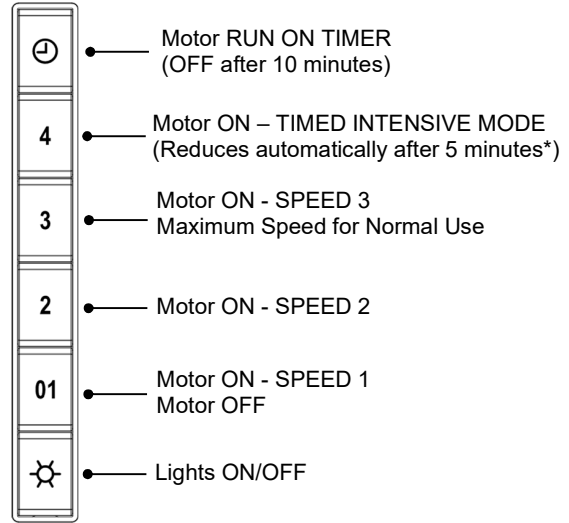

The extractor controller automatically switches off the appliance if there has been no operator action for 4 hours.

After 30 hours accumulated running GREASE FILTER CLEANING will be signalled by all 6 indicators flashing. Reset by pressing (⌚).

\*\*Speed 4 reduces automatically to Speed 3 after 5 minutes

Light Dimming

To adjust the light intensity, press & hold (☼) until desired intensity is achieved.

Colour Changing

Ensure that the fan, lights & timer are off. Press and hold (⌚) until the lights illuminate. Then press and hold (☼) until the desired light colour is achieved. Press SPEED 1 button to confirm the desired light preference. (or + if using the remote control).

Remote Control Functions

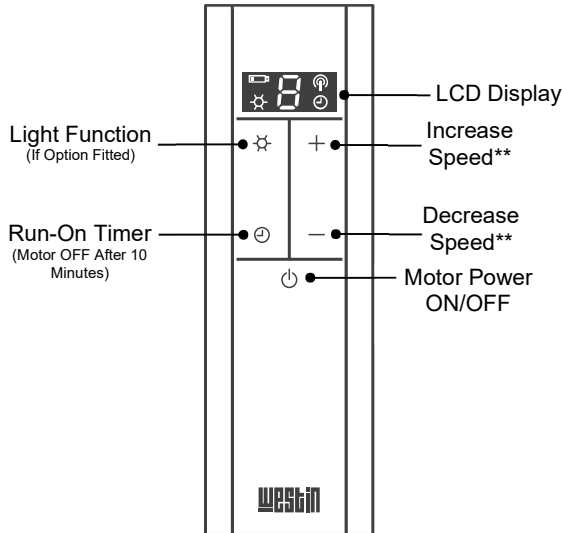

\* The automatic speed reduction feature is required by EU Ecodesign and Energy Labelling Commission Legislation 65/2015 66/2014 in order to satisfy Directive 2009/125 EC

The extractor controller will automatically switch off the appliance if there has been no operator action for 4 hours.

Refer to the instruction leaflet included with the radio remote control console regarding pairing the device, transmission codes and factory reset procedures.



Installation, Operating & Maintenance Instructions

7. MAINTENANCE

Regular maintenance is essential to ensure good performance and long-life.

**CAUTION.**

To minimise the risk of fire, all instructions relating to cleaning the grease filters and removing grease deposits must be adhered to.

To maintain the immaculate appearance of the extractor, and to minimise fire risk, ensure that grease deposits on the extractor surfaces are kept to a minimum by regular cleaning.

To clean the stainless-steel surfaces of the extractor, use a soft cloth and a suitable cleaning agent, such as a specially produced stainless-steel cleaner, or washing up detergent and warm water.

Painted surfaces should be cleaned using a soft cloth, detergent and warm water.

Glass surfaces should be cleaned with a suitable glass cleaning agent.

- **Do not use bleach-based cleaning products or abrasive materials.**

Clean the grease filters in a dishwasher or by hand-washing in hot water and detergent every 2 months - sooner if the extractor is used extensively and filters become grease laden.

- Whilst you can expect years of service from mesh grease filters, they are considered a consumable item and may deteriorate over time and need replacement, particularly when cleaned in a dishwasher. For dishwasher users adhering to a 2-monthly cleaning interval, we recommend grease filter replacement every 5 years to maintain optimum performance, even if they show no visible signs of deterioration. For all users, filters should be replaced whenever they exhibit signs of physical wear.

**Removing the Grease Filters**

The clip-in grease filters have an integrated sprung latch mechanism. Release the latch by pulling the lever and remove the filter.

Filters are replaced by locating the tabs opposite the lever into corresponding slots in the extractor base and then pushing the filter into position with the latch held open. Once the filter is in position release the lever, allowing the latch to engage.

**Removing the Carbon HEPA Filters**

The Carbon / HEPA filter should be replaced every 12 months to ensure optimum operation. The filter is not designed to be re-generated but can be air dried if the filter becomes saturated. Refer to the grease & HEPA filter removal diagram for instruction on how to replace the HEPA filter.

**Lamp replacement**

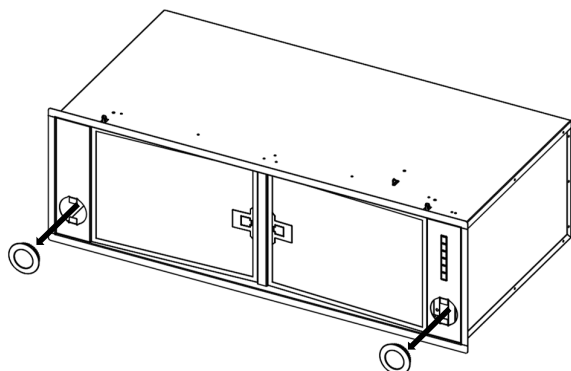

The long-life LED Lamps can be replaced as follows; Pull the lamp from behind to separate from the extractor body. The lamp should be unplugged and replaced with the new lamp. Connect the new lamp plug socket and push the new lamp into place (which will be retained in position once the back of the lamp body meets with the extractor surface). Only lamps supplied by Westin should be used. In the event of any difficulty please call Westin.

**Maintaining the 360 Air Cleaning Module**

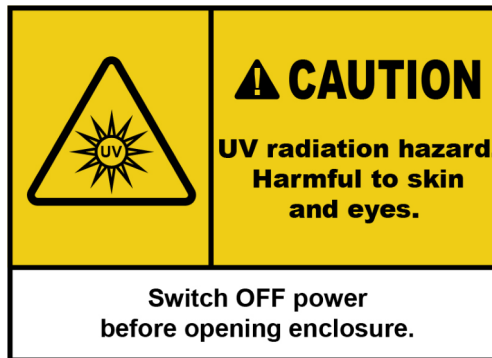

In order to ensure continued effectiveness, the 360 Air Cleaning Module requires only minimal routine maintenance.

The 360 Air Cleaning Module is located behind the small access panel on the side of the angled Air Box (only visible with left-hand filters removed). Refer to the forthcoming illustrations to remove the access panel for bulb replacement.

- The 360 Air Cleaning Module requires no cleaning of the special UV-C Composite lamp itself.
- The special UV-C Composite lamp provides the power source for the air cleaning reactor and requires periodical replacement to continue to operate at optimum power output.

We recommend that the lamp is replaced annually and not less frequently than every 3 years in order to ensure continued operation at optimum power output.

Replacement lamps are available from Westin and are supplied for installation by the end user.

Only replacement UV-C lamps supplied by Westin should be used in your Prime 360

*Note: Lamps which appear similar are available, for applications such as aquatic sterilisation, however, many do not directly generate super-oxidants. Furthermore, the super-oxidant directly generated by our lamp provides a precise and safe dose into the airstream.*

**PRIME RANGE Built-in Unit**  
**Installation, Operating & Maintenance Instructions**

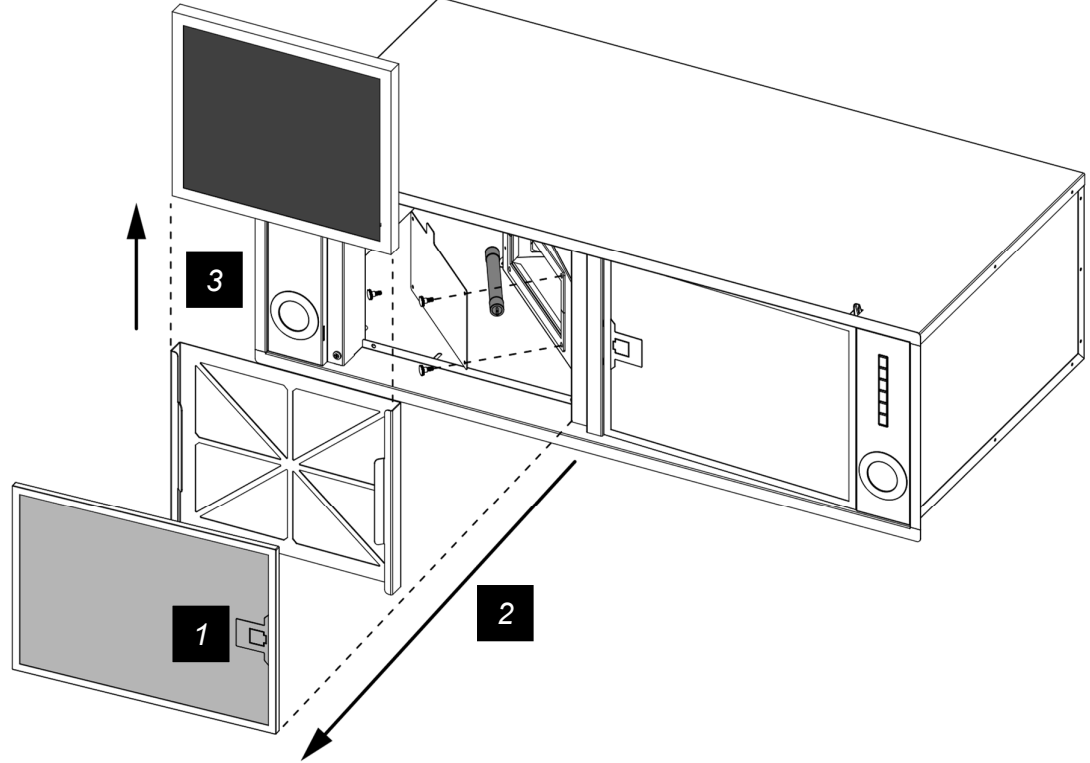

**Grease & HEPA Filter Removal**

4. Lift release lever & pull grease filter away from chassis.
5. Grasp steel frame surrounding HEPA filter and pull down to release frame from magnets.
6. Slide the HEPA filter sideways away from the HEPA filter frame.

**Grease & HEPA Filter Removal**

1. Lift release lever & pull grease filter away from chassis.
2. Grasp steel frame surrounding HEPA filter and pull down to release frame from magnets.
3. Slide the HEPA filter sideways away from the HEPA filter frame.

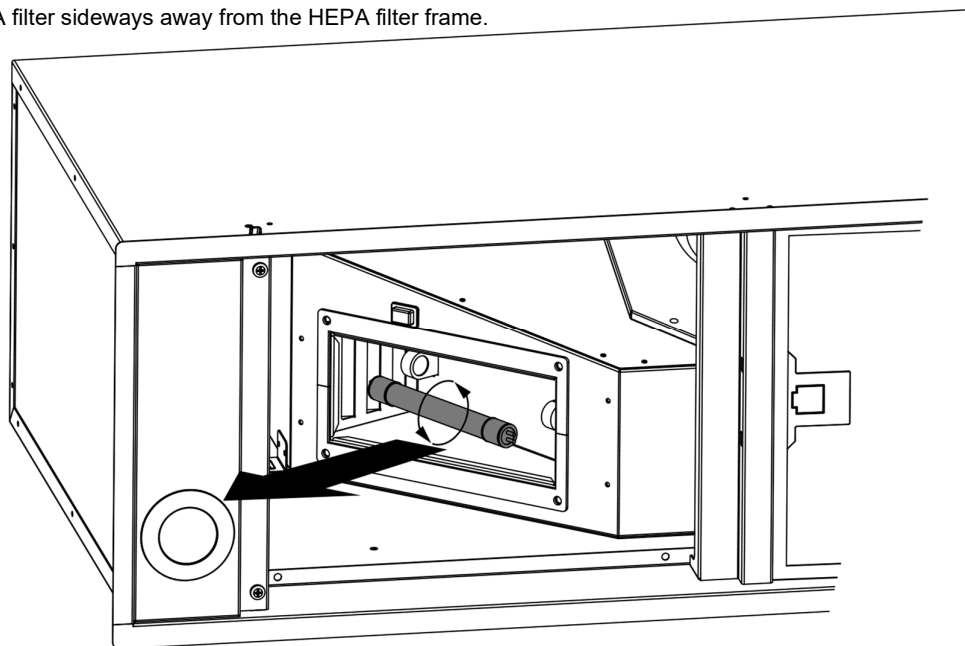

# PRIME RANGE Built-in Unit

## Installation, Operating & Maintenance Instructions



### 8. GENERAL ARRANGEMENT DRAWINGS & ILLUSTRATIONS

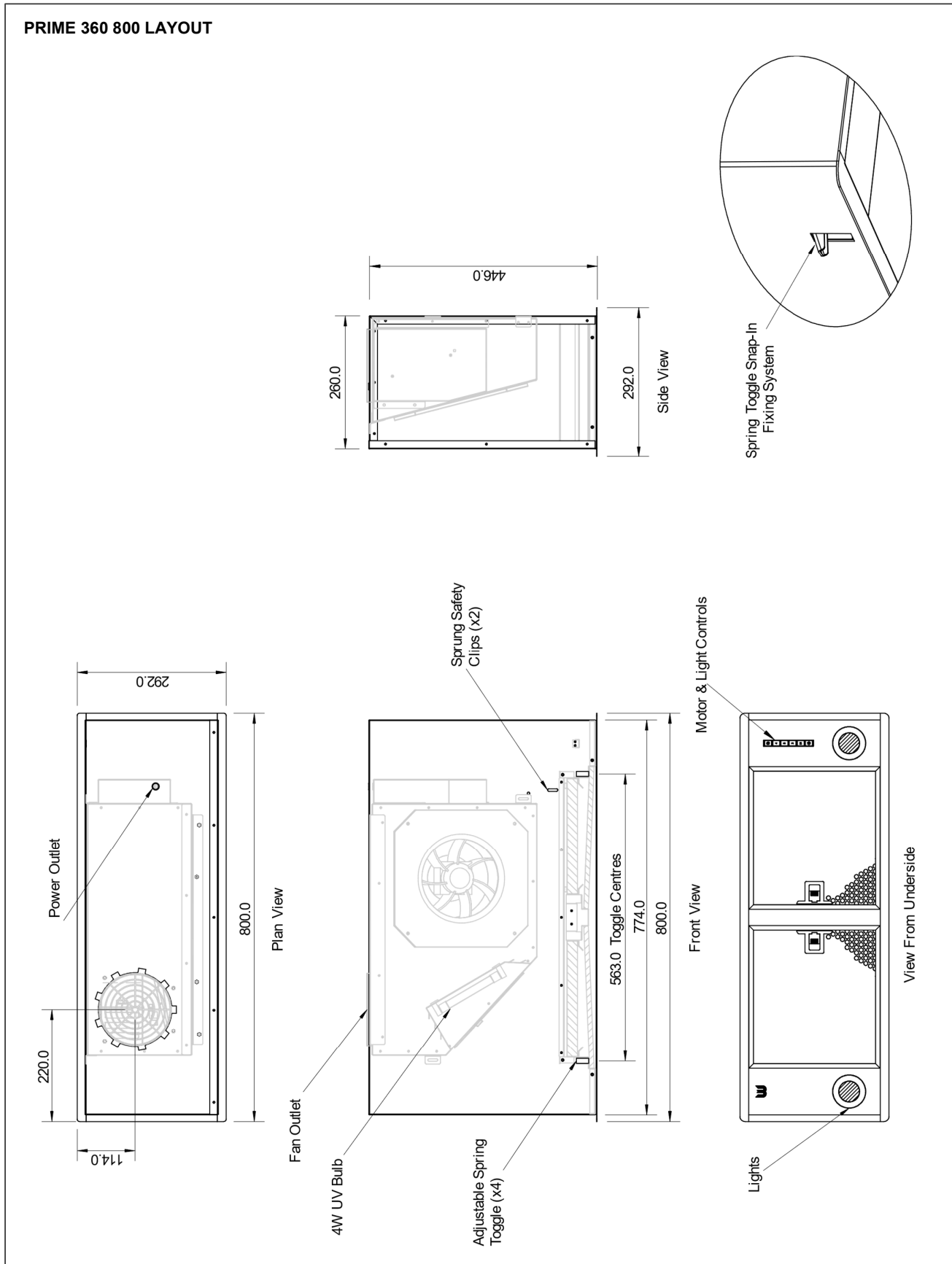



# PRIME RANGE Built-in Unit

## Installation, Operating & Maintenance Instructions



### PRIME 360 900 LAYOUT

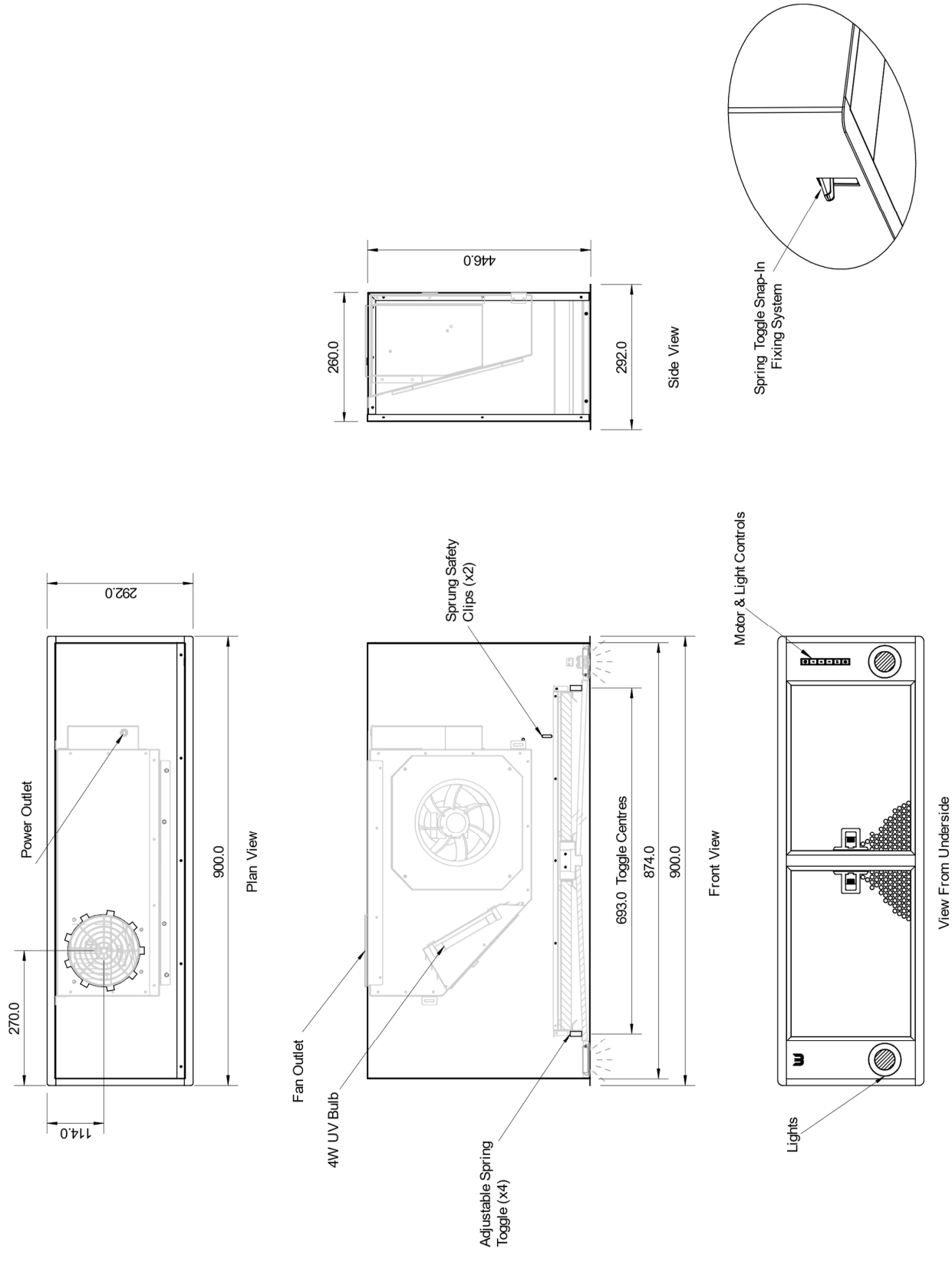

# PRIME RANGE Built-in Unit

## Installation, Operating & Maintenance Instructions



### PRIME 360 1100 LAYOUT

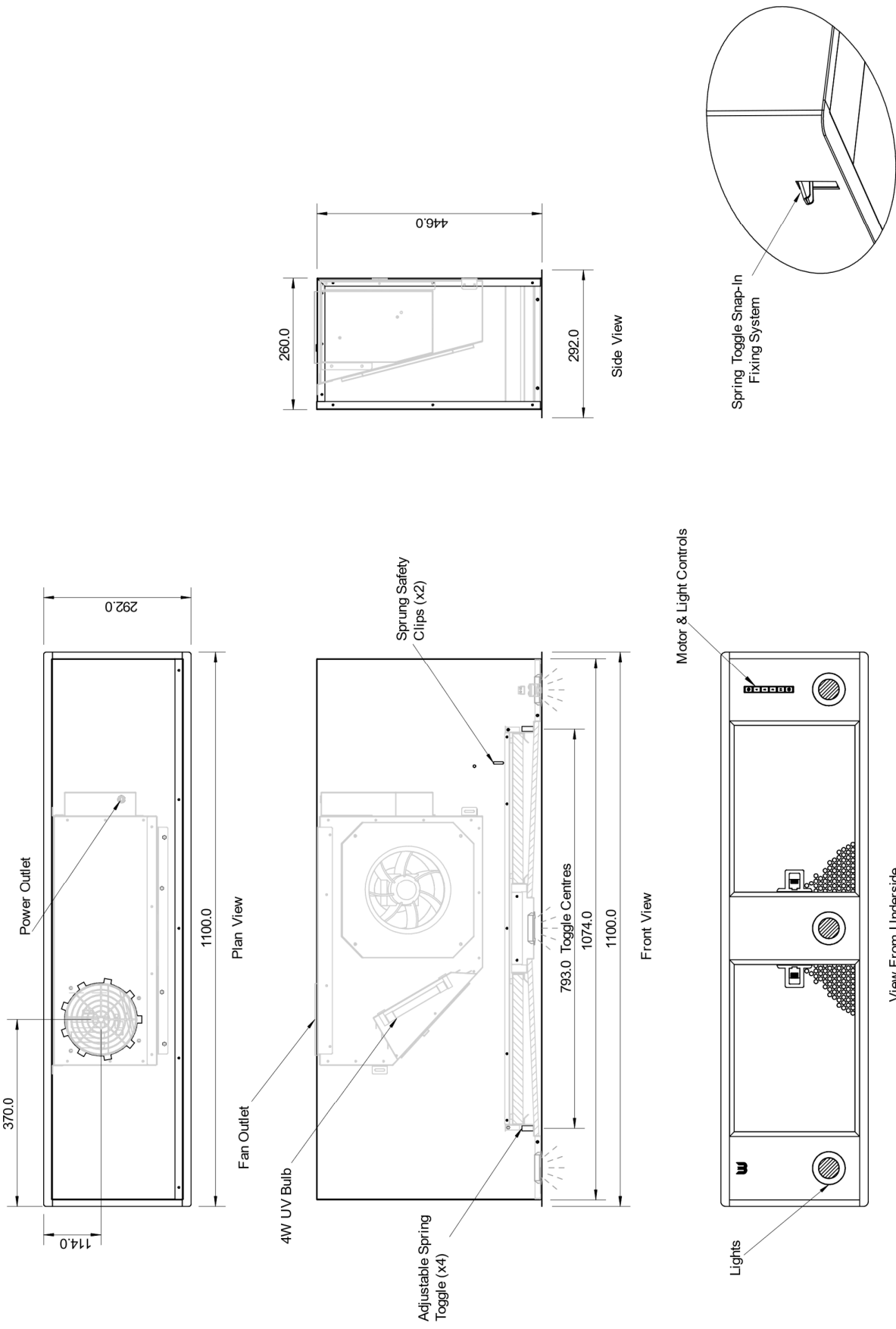



PRIME 360 1100 EXPLODED PARTS DIAGRAM

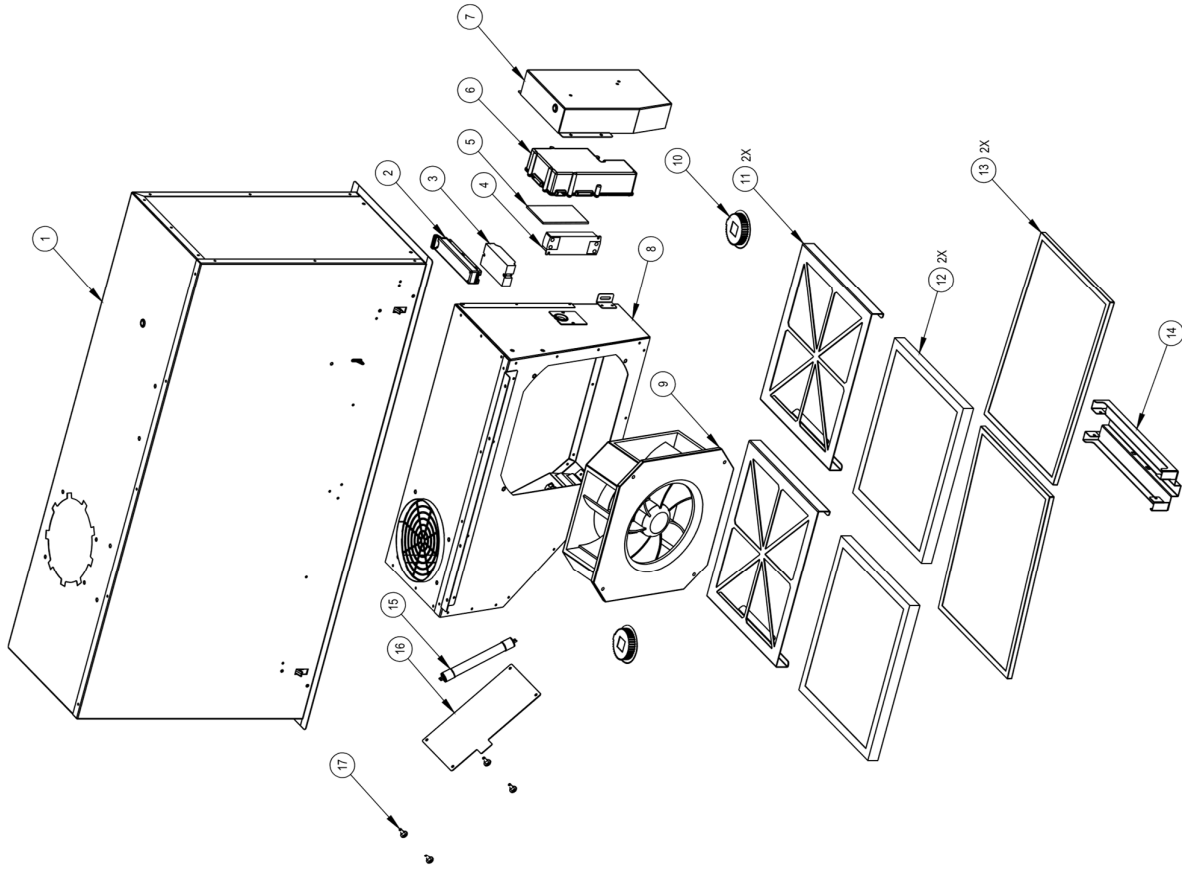

NO.	Part Name	Part Number	Notes & Special Ordering Instructions
1	Extractor Body	Made to Order	State Hood Size
2	Pushbutton Assembly	W1741	Non-user Servicable
3	UV Ballast	W2272	Non-user Servicable
4	Lighting Driver	W1094	Non-user Servicable
5	Electronics PCB	*W2191	Non-user Servicable
6	Circuit Board Housing	*W0419	Non-user Servicable
7	Gear Tray Enclosure	Made to Order	
8	Air Box	Made to Order	
9	Fan	W1805	Non-user Servicable
10	LED Lamp	W1729	800mm, 900mm Widths: x2 Lamps. 1100mm Width: x3 Lamps
11	Carbon HEPA Filter Cartridge	Made to Order	State Hood Size
12	Carbon / HEPA Filter	800mm Width: x2 W2362, 900mm & 1100mm Width: x2 W2361	
13	Grease Filter	800mm Width: x2 W1281, 900mm & 1100mm Width: x2 W0711	
14	Baseplate Centre Pod	Made to Order	
15	UV Bulb 4W	W2263	State Hood Size User Replace
16	UV Hatch Plate	Made to Order	
17	Thumb Screw	W2261	
18	Complete Fan Control Assembly	W2017	Includes asterisk items
19	Remote Control	W1798	

**PRIME RANGE Built-in Unit**  
**Installation, Operating & Maintenance Instructions**



**Toggle & Safety Clip System Illustrations**

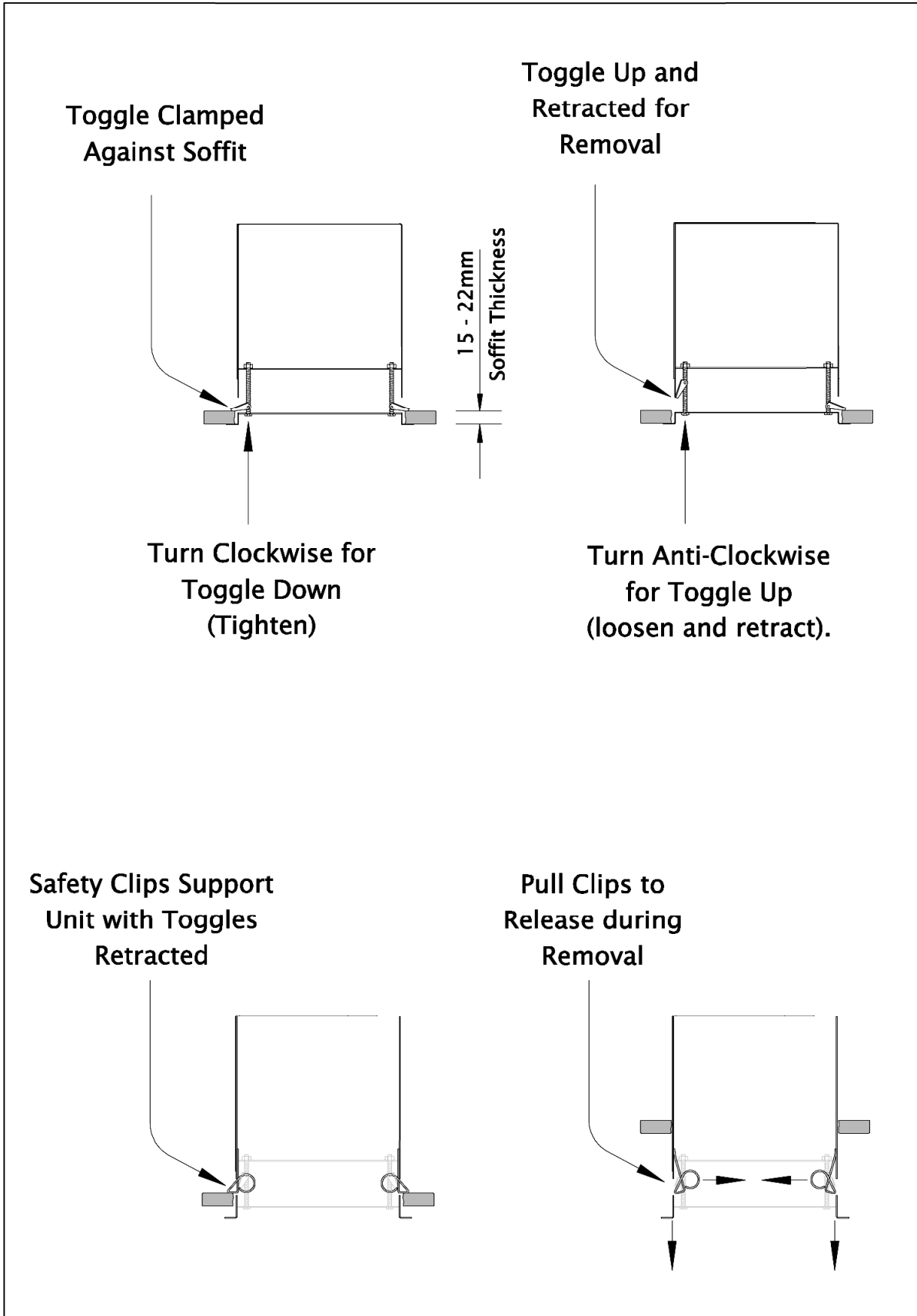

**PRIME RANGE Built-in Unit**  
**Installation, Operating & Maintenance Instructions**



**STANDARD GUARANTEE CONDITIONS**

Westin Ltd undertakes that if within 24 months of the date of delivery this product or any part thereof is proved to be defective by reason only of the faulty workmanship or materials, the company will, at our option, repair or replace the same FREE OF ANY CHARGE for labour, materials or carriage on condition that:

1. The product has been correctly installed and used only on the electrical supply stated on the rating plate.
2. The product has been used for normal domestic purpose only, and in accordance with the manufacturer's operating and maintenance instructions.
3. The product has not been serviced, maintained, repaired, taken apart or tampered with by any person not authorised by us.

**EXCLUSIONS**

**This Guarantee does not cover:**

- Damage or calls resulting from incorrect installation, transportation, improper use or neglect, the replacement of any light bulbs or removable parts of glass or plastic
- Costs incurred for calls to put right appliances improperly installed or calls to appliances outside the United Kingdom
- Normal wear and tear
- Products deemed to be in use within a commercial environment
- Grease filter mesh
- Bulbs and LEDs
- Consumables
- Damage caused to the body by usage of detergent sprayer or other contaminants
- Damage or corrosion of the LED parts, glass parts and stainless-steel parts
- Damage caused by foreign objects or accident
- Any products taken apart or serviced by unauthorised individuals or service engineers or replaced with other manufacturer's components
- Product not installed with the correct size ducting as stated in the manual

This Guarantee is in addition to your statutory and legal rights.

Please see our website [www.westin.co.uk](http://www.westin.co.uk) for details of our Conditions of Sale and to register your guarantee.